

Sintered filter element, adjustable

Operating pressure 0 to 20 bar  
 Operating temperature -10 °C to 600 °C  
 Pore size 35 to 50 µm  
 Material Stainless steel 1.4401

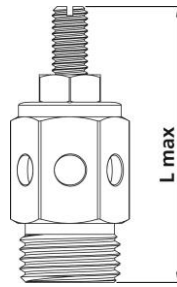
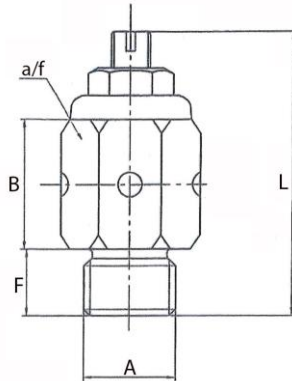

SD38ESEB

### Silencer, sintered stainless steel, stainless steel housing, adjustable

Art. No.	Type No.	Thread A	F mm	B mm	a/f mm	L mm	L max. mm
156524	SD18ESEB	G 1/8	6.0	14.0	13	29.0	39.0
156525	SD14ESEB	G 1/4	8.5	16.5	14	35.5	48.0
156526	SD38ESEB	G 3/8	10.0	17.5	17	38.0	50.0
156527	SD12ESEB	G 1/2	10.5	19.0	22	42.5	53.0
156528	SD34ESEB	G 3/4	13.5	24.0	27	49.5	65.5
156529	SD1ESEB	G 1	15.5	25.0	34	51.5	70.0

### Flow rates and Noise levels

Art. No.	Type No.	Flow rate l/min.	Noise level, reduced
156524	SD18ESEB	200	≥ 23 dB(A)
156525	SD14ESEB	290	≥ 27 dB(A)
156526	SD38ESEB	330	≥ 22 dB(A)
156527	SD12ESEB	530	≥ 18 dB(A)
156528	SD34ESEB	1650	≥ 12 dB(A)
156529	SD1ESEB	2400	≥ 13 dB(A)

- The use of silencers does not automatically reduce exhaust noise to a safe level.  
The need for other noise-reducing measures, such as hearing protection, must be assessed as well.
  
- Uses and applications are the responsibility of the user. However, it is necessary to carry out appropriate tests before use in order to convince yourself of the desired function under the respective conditions.  
All further claims, in particular liability for consequential damages, are excluded in principle.

Non-binding standard values, depending on the application and adaptation. The suitability test for the respective application is the responsibility of the user.